

Family: Bolla | Item No. 4668 BN/OB

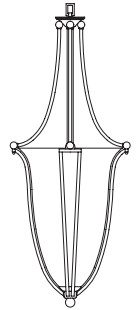

Drawing 1 - Fixture Assembly

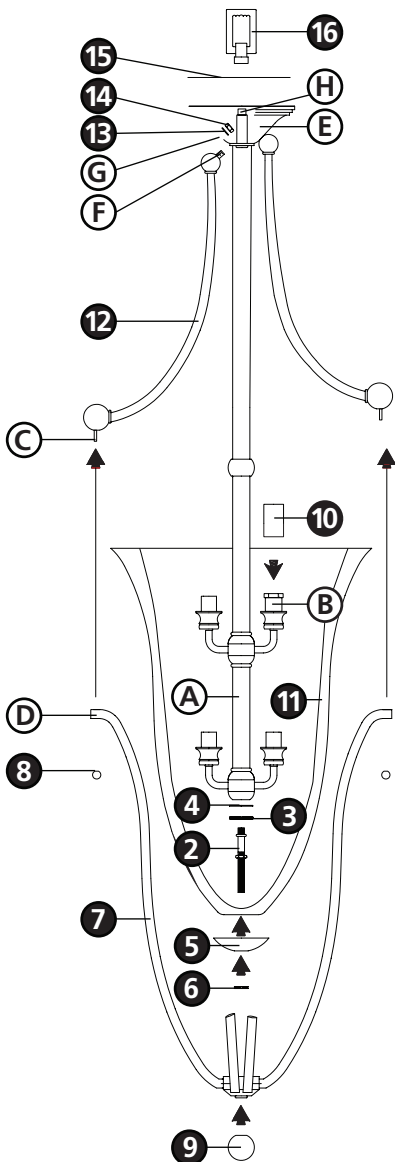

▼ start here

1

1. Find a clear area in which you can work.
2. Unpack fixture and glass from carton.
3. Carefully review instructions prior to assembly.

***** The construction of this fixture will be accomplished by first assembling the main body of the fixture, making all necessary electrical connections, hanging the fixture from the ceiling, and then installing the glass.**

SAFETY WARNING: READ WIRING AND GROUNDING INSTRUCTIONS (I.S. 18) AND ANY ADDITIONAL DIRECTIONS. TURN POWER SUPPLY OFF DURING INSTALLATION. IF NEW WIRING IS REQUIRED, CONSULT A QUALIFIED ELECTRICIAN OR LOCAL AUTHORITIES FOR CODE REQUIREMENTS.

2

1. To assemble main body, attach uprights (12) to top canopy (E) by inserting nipple (F) through holes (G) and threading on lockwasher (13) and hex nut (14).
2. Slide plate (15) and loop (16) along wire.
3. Thread loop (16) onto nipple (H).
4. Thread bottom center stem (2) into bottom of candle cluster (A).
5. Slip candle sleeves (10) over the sockets (B).
6. Please refer to hanging instruction sheet (I.S. 19-50) provided to continue installation of this fixture. Then refer back to this sheet to install glass.

3

1. Prior to installing glass, fixture can now be lamped accordingly.
2. To install glass, place rubber washer (4) and steel washer (3) into bottom of glass (11) and align center holes.
3. Slip glass (11) onto center stem (2).
4. While holding glass (11) in place, slip cap (5) onto center stem (2).
5. Thread knurl nut (6) onto center stem (2) and hand tighten.
Note: tightening knurl nut (6) with a tool could cause glass damage.
6. Slip cage (7) onto center stem (2) and align studs (C) with holes (D) in cage uprights (E).
7. Thread on finial (9).
8. Thread small ball knobs (8) onto end of studs (C) that are protruding from the bottom of holes (D).

Note: Maximum wattage for 4668 fixture is 60 watts per bulb.

2.7.08