

BENTLEY

FR44504BBZ/ANI

Bulbs: 4-60 W CAND.

Replacement Parts: Crystals: R44504CRY, R44505CRY

Shade: R44504SH

[DRAWING 1]

ASSEMBLY INSTRUCTIONS

Assembly of this fixture will be accomplished by assembling the main body of the fixture, installing the mounting hardware to the junction box, making all necessary electrical connections and then hanging the fixture.

SAFETY WARNING: Read wiring and grounding instructions [FRIS 18] and any additional directions. Turn power supply off during installation. If new wiring is required, consult a qualified electrician or local authorities for code requirements.

STEP 1

- 1 Slip center stem (1) along wire and thread onto threaded tube (2), located on the top of the main body (3) - See Drawing 1.
Making sure that every other arm of the spider (8) is located over one of the lower arms of the main body (3).
- 3 Slip candle sleeve (4) over socket (5).
- 4 Attach one end of shade rod (6) to the arm of the spider (7) that is located between the lower arms of the main body.

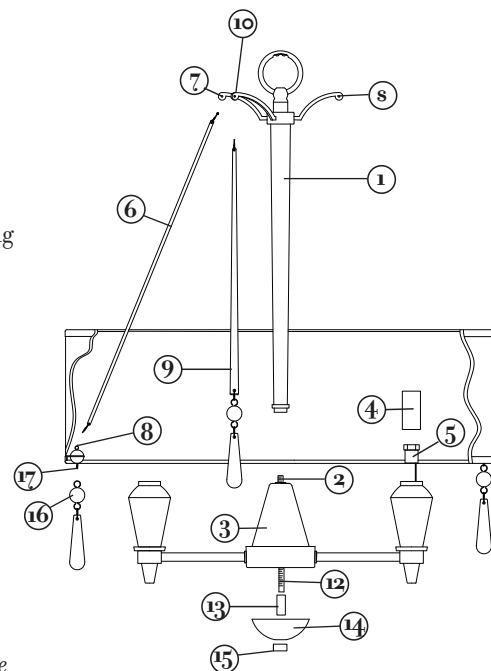

STEP 2 Refer to Hanging Instruction Sheet [FRIS19-100] to hang fixture and complete assembly.

STEP 3

- 1 Attach crystal (9) to spider arm (10) that is located over the arms of the main body (3).
- See Drawing 1.
- 2 Attach the free end of shade rod (6) to loop (8) located inside the shade (11) rim.
repeat process with remaining shade rods.
- 3 Slip polished tube cover (13) over tube (12), followed by crystal (14). Hold parts in position.
- 4 Thread decorative knob (15) onto end of tube (12) and tighten.
- 5 Attach crystal (16) to hook located on the bottom of the shade rim at location (17).
- 6 Fixture can now be lamped accordingly.



FREDRICK RAMOND
ESTABLISHED 1965

A Division of Hinkley Lighting, Inc.
33000 PIN OAK PARKWAY | AVON LAKE, OHIO 44012
toll free 800.446.5539 | phone 440.653.5500 01.01.11

WIRING AND GROUNDING INSTRUCTIONS

SAFETY WARNING:

Read wiring and grounding instructions [FRIS 18] and any additional directions. Turn power supply off during installation. If new wiring is required, consult a qualified electrician or local authorities for code requirements.

STEP 1 WIRING INSTRUCTIONS**Indoor Fixtures**

- 1 Connect positive supply wire (a) (typically black or the smooth, unmarked side of the two-conductor cord) to positive fixture lead (b) with appropriately sized twist on connector - See Drawings 1 or 2.
- 2 Connect negative supply wire (c) (typically white or the ribbed, marked side of the two-conductor cord) to negative fixture lead (d).
- 3 Please refer to the grounding instructions below to complete all electrical connections.

Outdoor Fixtures

- 1 Connect positive supply wire (a) (typically black or the smooth unmarked side of the two-conductor cord) to positive fixture lead (b) with appropriately sized twist on connector - See Drawings 2 or 3.
- 2 Connect negative supply wire (c) (typically white or the ribbed, marked side of the two-conductor cord) to negative fixture lead (d).
- 3 Cover open end of connectors with silicone sealant to form a watertight seal.
 - If installing a wall mount fixture, use caulk to seal gaps between the fixture mounting plate (backplate) and the wall. This will help prevent water from entering the outlet box. If the wall surface is lap siding, use caulk and a fixture mounting platform specially.
- 4 Please refer to the grounding instructions below to complete all electrical connections.

STEP 2 GROUNDING INSTRUCTIONS**Flush Mount Fixtures**

For positive grounding in a 3-wire electrical system, fasten the fixture ground wire (e) (typically copper or green plastic coated) to the fixture mounting strap (1) with the ground screw (2) - See Drawing 1.

Note: On straps for screw supported fixtures, first install the two mounting screws in strap.

Any remaining tapped hole may be used for the ground screw.

Chain Hung Fixtures

Loop fixture ground wire (e) (typically copper or green plastic coated) under the head of the ground screw (2) on fixture mounting strap (1) and connect to the loose end of the fixture ground wire directly to the ground wire of the building system with appropriately sized twist-on connectors - See Drawing 2.

Post-Mount Fixtures

Connect fixture ground wire (e) (typically copper or green plastic coated) to power supply ground with appropriately sized twist-on connector inside post. Cover open end of connector with silicone sealant to form a watertight seal - See Drawing 3.

[drawing 1]

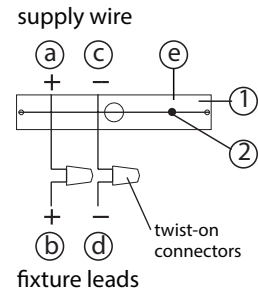

[drawing 2]

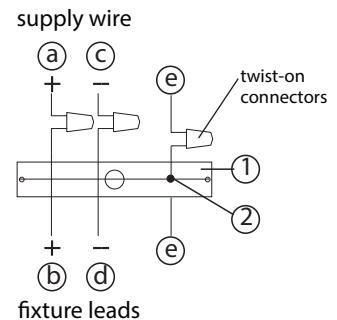

[drawing 3]

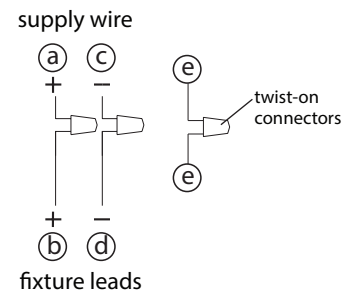

FREDRICK RAMOND
ESTABLISHED 1965

A Division of Hinkley Lighting, Inc.

33000 PIN OAK PARKWAY | AVON LAKE, OHIO 44012
toll free 800.446.5539 | phone 440.653.5500

FRIS19-100

HANGING INSTRUCTIONS

Replacement Parts: CRYSTAL: R44500CRY

SAFETY WARNING: Read wiring and grounding instructions [FRIS 18] and any additional directions. Turn power supply off during installation. If new wiring is required, consult a qualified electrician or local authorities for code requirements.

STEP 1

- 1 Shut off electrical current before starting. If the fixture you are replacing is turned on and off by a wall switch, simply turn the switch off. If not, remove the appropriate fuse (or open the circuit breakers) until the fixture is dead.
 - DO NOT restore current - either by fuse, breaker or switch - until the new fixture is completely wired and in place.

STEP 2

- 1 Fasten mounting strap (1) to outlet box (a) with the original outlet box screws (2) - See Drawing 1.
- 2 Thread nipple (3) into mounting strap (1).
- 3 Thread loop (4) on to end of nipple (3).
- 4 Slip canopy (b) and optional spider (7) over loop (4) and adjust height of loop so half of thread area is exposed.
NOTE: longer screw collar loop is to be used when using the spider and crystal accent on the canopy. Short screw collar loop is to be used when not using spider and crystal accent. see Drawing -2.

STEP 3

- 1 Taking the chain, determine the length you require to hang the fixture.
- 2 Attach one end of the chain to the top loop of the fixture - See Drawing 2.
- 3 Now slip loop collar (5), optional spider (7) and canopy (b) onto chain.
- 4 Attach other end of chain to loop (4). Get assistance for this step since fixture may be heavy and difficult to hold while attaching the chain.

STEP 4

- 1 Unwrap supply wire and ground wire and weave them up through the chain.
- 2 Slip supply wire and ground wire through center of loop (4).
- 3 Connect ground wire to mounting strap (1) using green ground screw (6).
- 4 Make electrical connections from supply wire to fixture lead wires. Refer to instruction sheet [FRIS18] and follow all instructions to make all necessary wiring connections.
- 5 Slip canopy up firmly against the ceiling followed by the spider (7). thread collar (5) onto loop (4) to secure canopy and spider.
NOTE: spider (7) and crystal drop is optional .
- 6 Attach crystal drops (8) to end of spider (7).

[DRAWING 1]

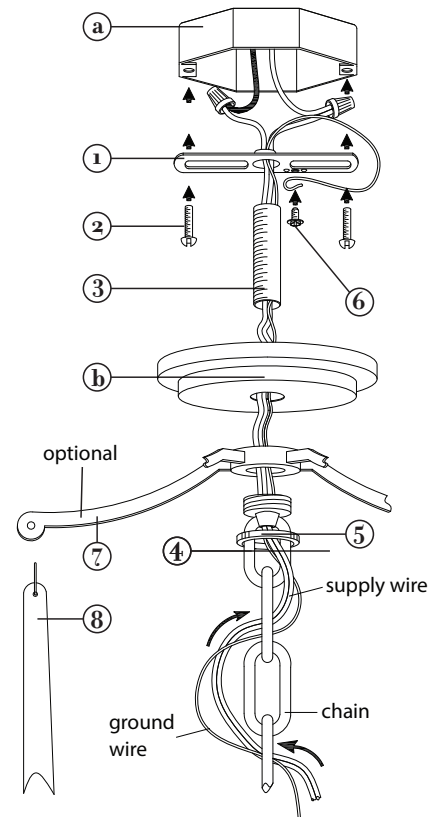

[DRAWING 2]

Half of thread area of loop (4) is to be exposed. This will allow collar (5) to be threaded on later.

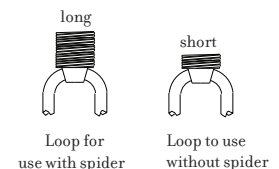
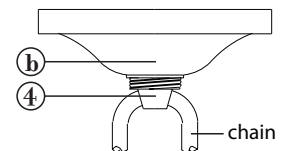

FREDRICK RAMOND
ESTABLISHED 1965

A Division of Hinkley Lighting, Inc.
33000 PIN OAK PARKWAY | AVON LAKE, OHIO 44012
toll free 800.446.5539 | phone 440.653.5500